

ASSEMBLY INSTRUCTION

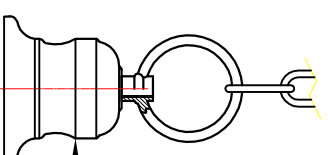

A Top metal cover

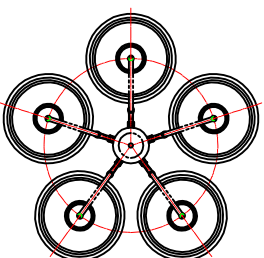
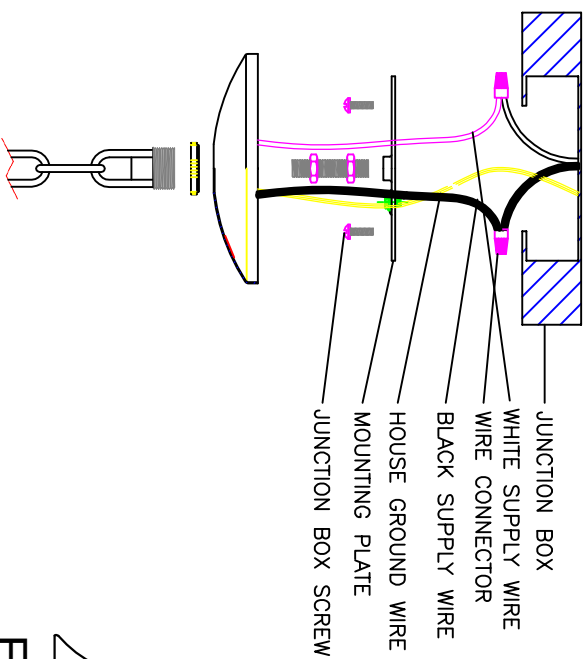
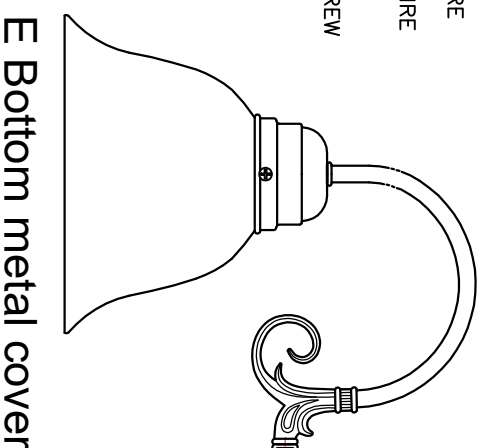

E Bottom metal cover

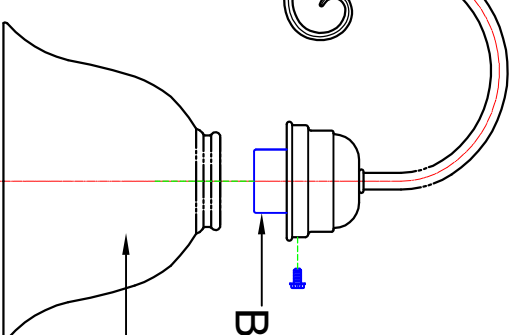

B Socket

C Glass

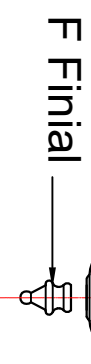

F Finial

ASSEMBLY PROCEDURES:

1. Shut off power
2. Fix the Canopy on the junction box and connect the wires.
3. Install the Bottom metal cover (E) and top metal cover (A) to the center of the component by Finial (F)
4. Install the glass and secure it by socket (B)
5. Install the bulb (Bulb not included)