

ASSEMBLY AND INSTALLATION INSTRUCTIONS

WARNING: TO AVOID RISK OF ELECTRICAL SHOCK, BE SURE TO SHUT OFF POWER WHILE INSTALLING OR SERVICING THIS FIXTURE.

NOTE : Before installing, consult local electrical codes for wiring and grounding requirement

1. Fix the glass sheet onto the fixture by finial A and finial B. At the top and bottom of the shade, there may need to be a plastic ring added between finial A and the fixture if it is fixed loosely.
2. Fix the backplate to the outlet box using 2 outlet box screws.
3. Make wire connections:
 - Attach ground wire to house ground wire using a wire nut or attach them to the backplate with a green ground screw.
 - Attach white wire from light to white wire from power source with a wire nut.
 - Attach black wire from light to black wire from power source with a wire nut.

Observing: positive wire with positive wire, negative wire with negative wire, ground wire with ground wire.

4. Tuck the wire connections neatly into the outlet box.
5. Aim the faceplate to the two holes of screws on the backplate, and secure the supplied screws onto top and bottom of the faceplate.
6. Install bulb.(not included) (Please do not exceed the maximum capacity which is recommended on the fixture.)
7. Turn on the power at fuse or circuit box.

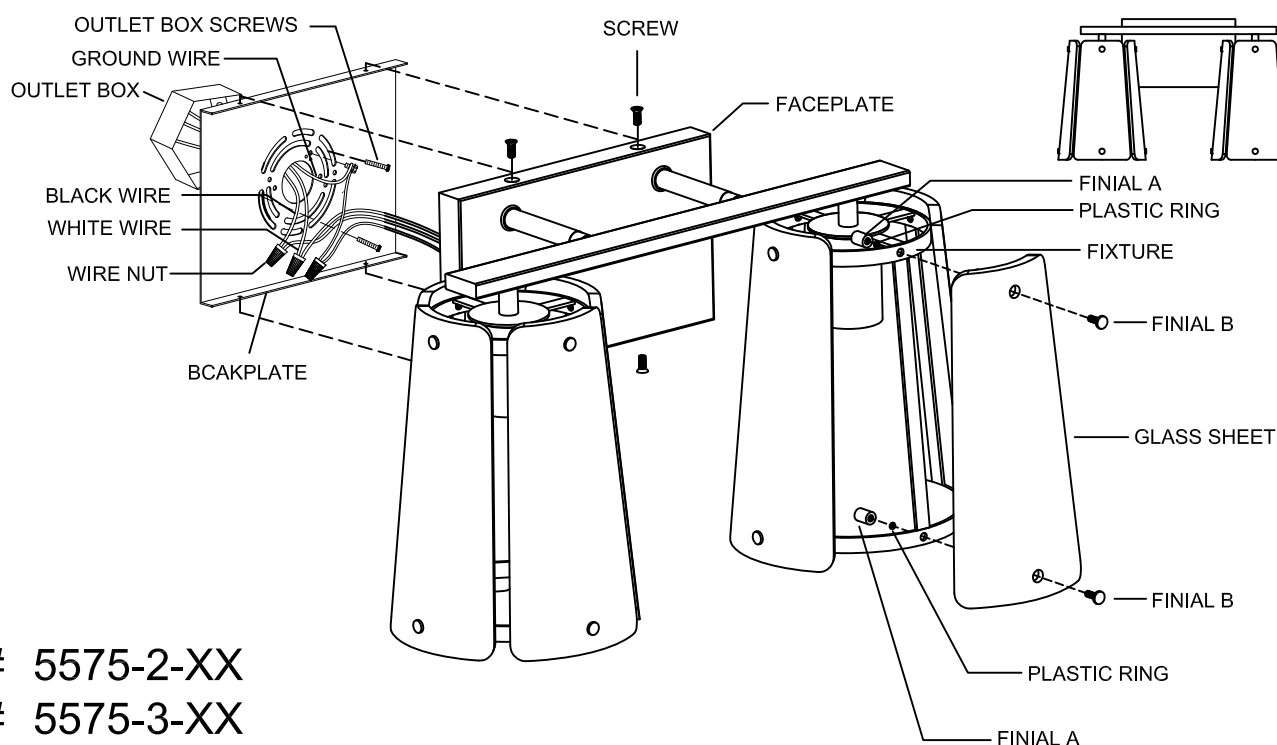
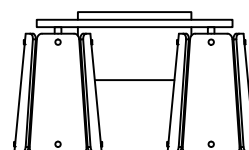
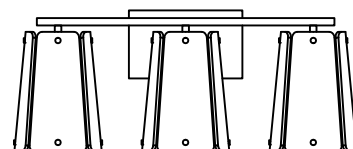
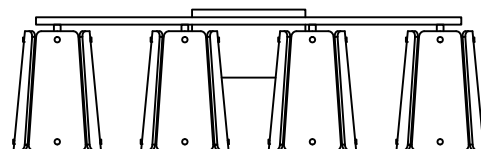

5575-2-XX
5575-3-XX
5575-4-XX