

ASSEMBLY AND INSTALLATION INSTRUCTIONS

WARNING:

TO AVOID RISK OF ELECTRICAL SHOCK, BE SURE TO SHUT OFF
POWER WHILE INSTALLING OR SERVICING THIS FIXTURE.

NOTE: Before installing, consult local electrical codes for wiring and grounding requirement.

1. Let the two supplied screws pass through the holes specially provided on the universal crossbar and lock them by hex nuts.
 2. Fix the universal crossbar to the outlet box using 2 outlet box screws.
 3. Make wire connections:
 - Attach ground wire to house ground wire using a wire nut or attach them to the universal crossbar with a green ground screw.
 - Attach white wire from light to white wire from power source with a wire nut.
 - Attach black wire from light to black wire from power source with a wire nut.
- Observing: positive wire with positive wire, negative wire with negative wire, ground wire with ground wire.
4. Tuck the wire connections neatly into the outlet box.
 5. Aim the faceplate to the two supplied screws, then fasten it with the two ball nuts.
 6. Put glass shade onto the socket and fix it with tube. Attach the deco.drop onto the fixture.
 7. Install bulb.(not included) (Please do not exceed the maximum capacity which is recommended on the fixture.)
 8. Turn on the power at fuse or circuit box.

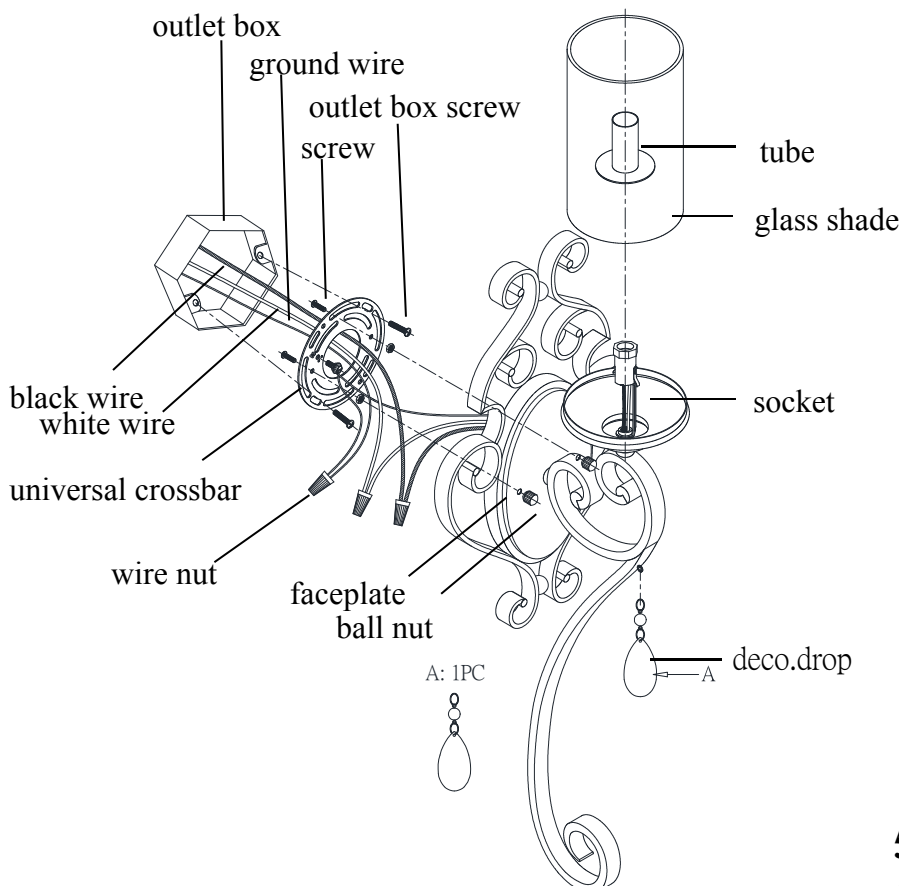

5473-1-39

5473-1-70