

ASSEMBLY AND INSTALLATION INSTRUCTIONS

WARNING:

TO AVOID RISK OF ELECTRICAL SHOCK, BE SURE TO SHUT OFF POWER WHILE INSTALLING OR SERVICING THIS FIXTURE.

NOTE: Before installing, consult local electrical codes for wiring and grounding requirement.

1. Fix the backplate to the outlet box using 2 outlet box screws.
 2. Make wire connections:
 - Attach ground wire to house ground wire using a wire nut or attach them to the backplate with a green ground screw.
 - Attach white wire from light to white wire from power source with a wire nut.
 - Attach black wire from light to black wire from power source with a wire nut.
- Observing: positive wire with positive wire, negative wire with negative wire, ground wire with ground wire.
3. Tuck the wire connections neatly into the outlet box.
 4. Aim the faceplate to the backplate, then fasten it with the four screws.
 5. Put candle sleeve onto the socket and install bulb (not included) (Please do not exceed the maximum capacity which is recommended on the fixture.)
 6. Twist the glass shade onto the socket cap, then put the deco. glass ring on the glass shade.
 7. Turn on the power at fuse or circuit box.

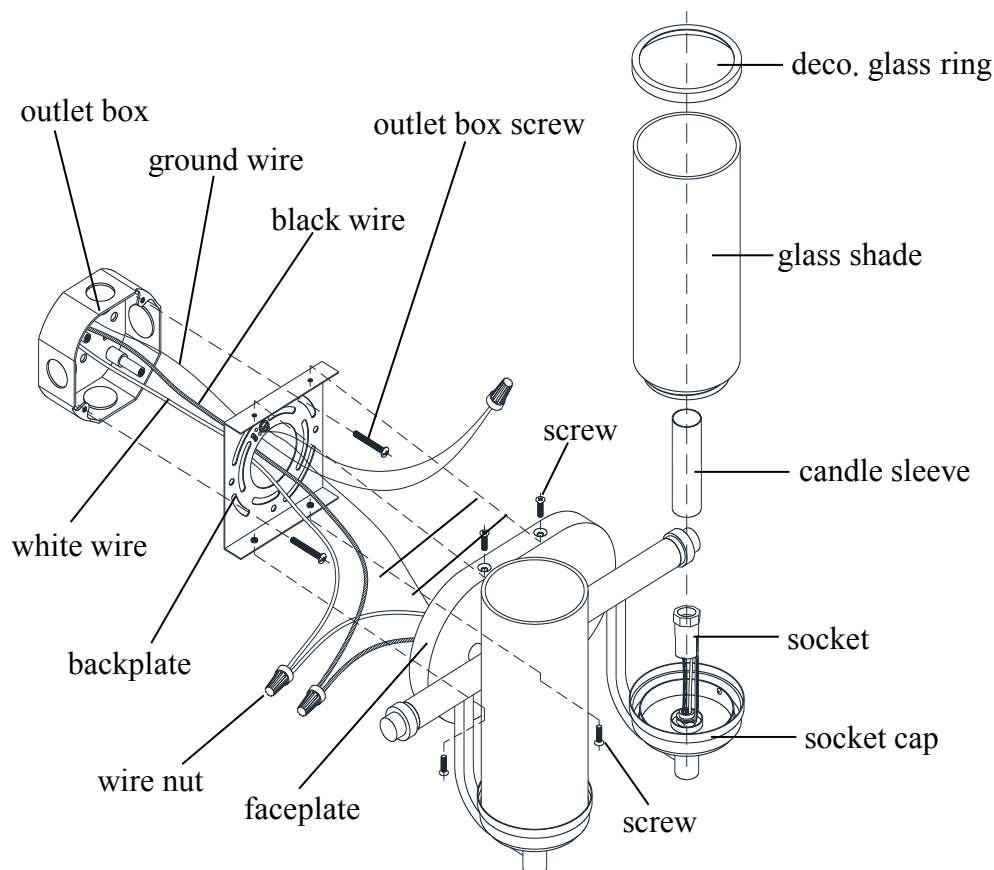

5044-2-65

5044-2-80

5044-2-86

5044-3-65

5044-3-80

5044-3-86

5044-4-65

5044-4-80

5044-4-86